

# JVC



## COMPACT COMPONENT SYSTEM

# VS-DT2000

Consists of CA-VSDT2000, SP-VSDT2000 and SP-PW2000

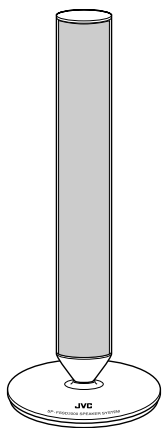

SP-VSDT2000

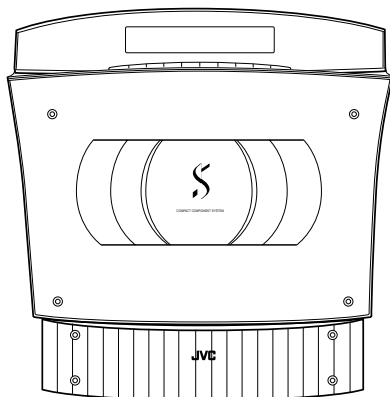

CA-VSDT2000

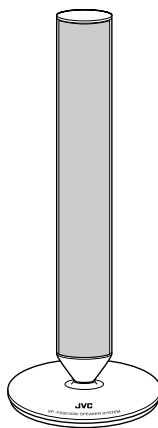

SP-VSDT2000

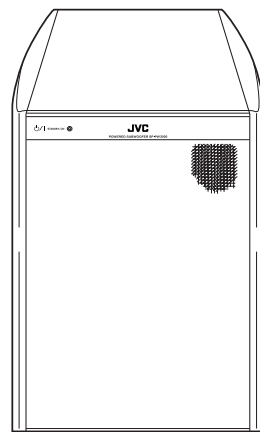

SP-PW2000

COMPACT  
**disc**  
DIGITAL AUDIO

## INSTRUCTIONS

**For Customer Use:**

Enter below the Model No. and Serial No. which are located either on the rear, bottom or side of the cabinet. Retain this information for future reference.

Model No. \_\_\_\_\_

Serial No. \_\_\_\_\_

LVT0854-001A

[J]

# Warnings, Cautions and Others / Mises en garde, précautions et indications diverses

(For U.S.A)

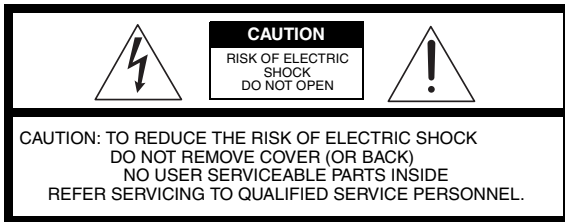

The lightning flash with arrowhead symbol, within an equilateral triangle is intended to alert the user to the presence of uninsulated "dangerous voltage" within the product's enclosure that may be of sufficient magnitude to constitute a risk of electric shock to persons.



The exclamation point within an equilateral triangle is intended to alert the user to the presence of important operating and maintenance (servicing) instructions in the literature accompanying the appliance.

**WARNING: TO REDUCE THE RISK OF FIRE OR ELECTRIC SHOCK, DO NOT EXPOSE THIS APPLIANCE TO RAIN OR MOISTURE.**

## INFORMATION

This equipment has been tested and found to comply with the limits for a Class B digital device, pursuant to Part 15 of the FCC Rules. These limits are designed to provide reasonable protection against harmful interference in a residential installation. This equipment generates, uses, and can radiate radio frequency energy and, if not installed and used in accordance with the instructions, may cause harmful interference to radio communications. However, there is no guarantee that interference will not occur in a particular installation. If this equipment does cause harmful interference to radio or television reception, which can be determined by turning the equipment off and on, the user is encouraged to try to correct the interference by one or more of the following measures:

- Reorient or relocate the receiving antenna.
- Increase the separation between the equipment and receiver.
- Connect the equipment into an outlet on a circuit different from that to which the receiver is connected.
- Consult the dealer or an experienced radio/TV technician for help.

### For Canada/pour le Canada

**CAUTION:** TO PREVENT ELECTRIC SHOCK, MATCH WIDE BLADE OF PLUG TO WIDE SLOT, FULLY INSERT.

**PRECAUTION:** POUR EVITER LES CHOCS ELECTRIQUES, INTRODUIRE LA LAME LA PLUS LARGE DE LA FICHE DANS LA BORNE CORRESPONDANTE DE LA PRISE ET POUSSER JUSQU'AU FOND

### For Canada/pour Le Canada

THIS DIGITAL APPARATUS DOES NOT EXCEED THE CLASS B LIMITS FOR RADIO NOISE EMISSIONS FROM DIGITAL APPARATUS AS SET OUT IN THE INTERFERENCE-CAUSING EQUIPMENT STANDARD ENTITLED "DIGITAL APPARATUS," ICES-003 OF THE DEPARTMENT OF COMMUNICATIONS.

CET APPAREIL NUMERIQUE RESPECTE LES LIMITES DE BRUITS RADIOELECTRIQUES APPLICABLES AUX APPAREILS NUMERIQUES DE CLASSE B PRESCRITES DANS LA NORME SUR LE MATERIEL BROUILLEUR: "APPAREILS NUMERIQUES", NMB-003 EDICTEE PAR LE MINISTRE DES COMMUNICATIONS.

1. CLASS 1 LASER PRODUCT
2. **DANGER:** Invisible laser radiation when open and interlock failed or defeated. Avoid direct exposure to beam.
3. **CAUTION:** Do not open the top cover. There are no user serviceable parts inside the unit; leave all servicing to qualified service personnel.

### CAUTION

To reduce the risk of electrical shocks, fire, etc.:

1. Do not remove screws, covers or cabinet.
2. Do not expose this appliance to rain or moisture.

1. PRODUIT LASER CLASSE 1
2. **ATTENTION:** Radiation laser invisible quand l'appareil est ouvert ou que le verrouillage est en panne ou désactivé. Eviter une exposition directe au rayon.
3. **ATTENTION:** Ne pas ouvrir le couvercle du dessus. Il n'y a aucune pièce utilisable à l'intérieur. Laisser à un personnel qualifié le soin de réparer votre appareil.

### ATTENTION

Afin d'éviter tout risque d'électrocution, d'incendie, etc.:

1. Ne pas enlever les vis ni les panneaux et ne pas ouvrir le coffret de l'appareil.
2. Ne pas exposer l'appareil à la pluie ni à l'humidité.

### Caution — $\phi/|$ switch! (CA-VSDT2000)

Disconnect the mains plug to shut the power off completely. The  $\phi/|$  switch in any position does not disconnect the mains line. The power can be remote controlled.

### Attention — Commutateur $\phi/|$ ! (CA-VSDT2000)

Déconnecter la fiche de secteur pour couper complètement le courant. Le commutateur  $\phi/|$  ne coupe jamais complètement la ligne de secteur, quelle que soit sa position. Le courant peut être télécommandé.

### Caution — POWER switch! (SP-PW2000)

This apparatus is provided with a POWER switch to be able to minimize power consumption for safe use. Therefore,

1. When doing initial setting, complete all the connections required, connect the mains plug into the wall outlet, and set the POWER switch to ON.

2. When not in use, set the POWER switch to OFF.
3. Disconnect the mains plug to shut the power off completely. The POWER switch in any position do not disconnect the mains line.

### Précaution — Interrupteur POWER (SP-PW2000)

Cet appareil est doté d'un interrupteur POWER qui permet de réduire la consommation d'énergie à des fins de sécurité. En conséquence,

1. Lors des réglages initiaux, effectuez tous les raccordements, branchez la fiche secteur dans la prise secteur, puis mettez l'interrupteur POWER sur ON.
2. Lorsqu'on ne se sert pas de l'appareil, mettez l'interrupteur POWER sur OFF.
3. Débranchez l'appareil de la prise secteur pour couper complètement l'alimentation. L'interrupteur POWER ne coupe pas l'appareil du secteur, quelle que soit la position sur laquelle il est réglé.

### CAUTION

#### ■ About the Internal Cooling Fan

This unit (CA-VSDT2000) includes an internal cooling fan, so as to allow for high-power operation within a small space. This fan comes on when the sound level is set high, and may also come on even at low sound levels if the internal temperature rises. To ensure effective fan operation, please leave at least 1 cm (7/16") clearance on each side of the unit.

### ATTENTION

#### ■ A propos du ventilateur de refroidissement interne

Cet appareil (CA-VSDT2000) est équipé d'un ventilateur de refroidissement interne afin de permettre un fonctionnement à haute puissance dans un espace limité. Ce ventilateur se met en marche quand le niveau sonore est élevé et peut aussi se déclencher même à un niveau bas si la température interne augmente. Pour garantir un fonctionnement effectif du ventilateur, veuillez laisser un espace libre de 1 cm au moins de chaque côté de l'appareil.

# Introduction

Thank you for purchasing the JVC Compact Component System. We hope it will be a valued addition to your home, giving you years of enjoyment. Be sure to read this instruction manual carefully before operating your new stereo system. In it you will find all the information you need to set up and use the system. If you have a query that is not answered by the manual, please contact your dealer.

## Features

Here are some of the things that make your System both powerful and simple to use.

- With the slot-loading CD mechanism, you can choose to place the System either vertically or horizontally.
- The controls and operations have been redesigned to make them very easy to use, freeing you to just enjoy the music.
  - With JVC's **COMPU PLAY** you can turn on the System and automatically start the Radio or CD Player with a single touch.
- The powered Subwoofer provides richness of bass in addition to faithful reproduction at low frequency.
- A 45-station preset capability (30 FM and 15 AM) in addition to auto-seek and manual tuning.
- CD options that include repeat, random and program play.
- Timer functions; Daily Timer and Sleep Timer.
- You can connect various external units, such as an MD recorder.
- The system can play CD-R and CD-RW after they have been **finalized**.
- You can play back your original CD-R or CD-RW recorded in Music CD format. (However they may not be played back depending on their characteristics or recording conditions.)



## How This Manual Is Organized

- Basic information that is the same for many different functions - e.g. setting the volume - is given in the section 'Basic Operations', and not repeated under each function.
- The names of buttons/controls and display messages are written in all capital letters: e.g. FM/AM, "CD NO DISC".
- System functions are written with an initial capital letter only: e.g. Normal Play.

Use the table of contents to look up specific information you require.

We have enjoyed making this manual for you, and hope it serves you in enjoying the many features built into your System.

## WARNINGS

- **DO NOT PUT ANYTHING ON THE PANEL. IF THE SYSTEM IS OPERATED WITH SOMETHING PUT ON THE PANEL, IT WILL BE DAMAGED WHEN YOU TRY TO OPEN THE PANEL.**
- **SUPPLIED SPEAKERS (SP-VSDT2000) ARE EXCLUSIVELY FOR THIS SYSTEM. USING WITH OTHER DEVICES WILL DAMAGE THE SPEAKERS.**

## IMPORTANT CAUTIONS

### 1 Installation of the System

- Select a place which is level, dry and neither too hot nor too cold. (Between 5°C and 35°C or 41°F and 95°F.)
- Leave sufficient distance between the System and a TV.
- Do not use the System in a place subject to vibrations.

### 2 Power cord

- Do not handle the power cord with wet hands!
- Some power is always consumed as long as the power cord is connected to the wall outlet.
- When unplugging the System from the wall outlet, always pull the plug, not the power cord.

### 3 Malfunctions, etc.

- There are no user serviceable parts inside. In case of system failure, unplug the power cord and consult your dealer.
- Do not insert any metallic object into the System.
- Do not insert your hand between the Panel and the main body when the Panel is being closed.

# Table of Contents

<b>Introduction .....</b>	<b>1</b>
Features .....	1
How This Manual Is Organized .....	1
WARNINGS .....	1
IMPORTANT CAUTIONS .....	1
<b>Getting Started .....</b>	<b>3</b>
Accessories .....	3
How To Put Batteries In the Remote Control .....	3
Connecting the FM Antenna .....	4
Connecting the AM Antenna .....	5
Connecting the Speakers (SP-VSDT2000) .....	6
Attaching the Spacers .....	7
Connecting the Powered Subwoofer (SP-PW2000) .....	7
Connecting External Equipment .....	7
Connecting an MD Recorder, etc (Digital Output) .....	8
Connecting the AC Power Cord .....	8
Installing the Unit on the Stand .....	8
Installing the Equipment on the Wall .....	9
Changing the Display and Control Buttons Settings .....	10
Using the Remote Control .....	11
COMPU Play .....	11
<b>Basic Operations .....</b>	<b>12</b>
Turning the Power On and Off .....	12
Adjusting the Brightness (DIMMER) .....	12
Changing the Color (COLOR) .....	13
Adjusting the Volume .....	13
Tone Control (BASS/TREBLE) .....	13
Showing the Time (DISPLAY) .....	13
<b>Using the Powered Subwoofer .....</b>	<b>14</b>
Operating the Powered Subwoofer .....	14
<b>Using the Tuner .....</b>	<b>16</b>
Tuning In a Station .....	16
Presetting Stations .....	17
To Change the FM Reception Mode .....	17
<b>Using the CD Player .....</b>	<b>18</b>
To Insert a CD .....	18
To Unload a CD .....	19
Basics of Using the CD Player — Normal Play .....	19
Programming the Playing Order of the Tracks .....	19
Random Play .....	20
Repeating Tracks .....	20
Child Lock .....	20
<b>Using External Equipment .....</b>	<b>21</b>
Listening to External Equipment .....	21
Recording the System's Source to External Equipment .....	21
<b>Using the Timers .....</b>	<b>22</b>
Setting the Clock .....	22
Setting the Daily Timer .....	23
Setting the SLEEP Timer .....	24
<b>Care And Maintenance .....</b>	<b>25</b>
<b>Troubleshooting .....</b>	<b>26</b>
<b>Specifications .....</b>	<b>Back cover</b>

# Getting Started

## Accessories

Make sure that you have all of the following items, which are supplied with the System.

- Power Cord (1)
- AM Loop Antenna (1)
- Remote Control (1)
- Batteries (2)
- FM Wire Antenna (1)
- Signal Cord (1)
- Spacers (4) (for SP-PW2000)
- Stand (1) (for Center Unit)
- Legs (2) (for Stand)
- Screw (1) (for Stand)
- Brackets (2) (for SP-VSDT2000)
- Wing Bolts (2) (for SP-VSDT2000)
- Paper Pattern (1)

If any of these items are missing, contact your dealer immediately.

## How To Put Batteries In the Remote Control

Match the polarity (+ and -) on the batteries with the + and - markings in the battery compartment.

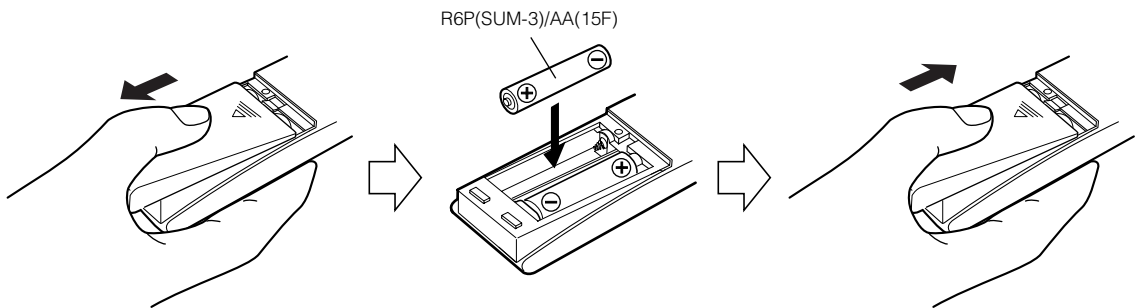

### **CAUTION:**

- Handle batteries properly.

#### ■ To avoid battery leakage or explosion:

- Remove batteries when the Remote Control will not be used for a long time.
- When you need to replace the batteries, replace both batteries at the same time with new ones.
- Do not use an old battery with a new one.
- Do not use different types of batteries together.

**CAUTION:**

- Make all connections before plugging the System into an AC power outlet.

**Note**

**(Only if you install the Center Unit vertically)**

- To place the Center Unit **vertically**, the Stand and Legs must be attached. (See page 8.) To make connections, let the cords pass in the holes of the Stand as shown in the diagram before attaching the Stand and Legs.

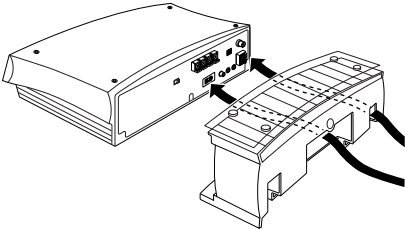

**Connecting the FM Antenna**

**Rear Panel of the Center Unit (CA-VSDT2000)**

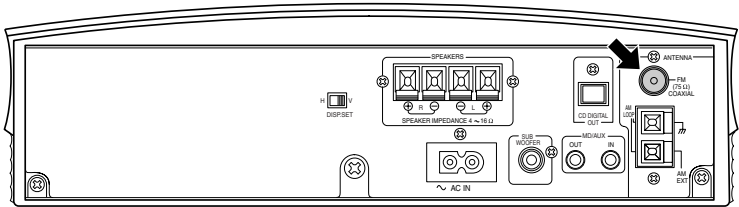

**Using the Supplied Wire Antenna**

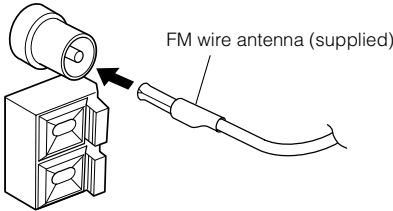

If reception is poor, connect the outdoor antenna.

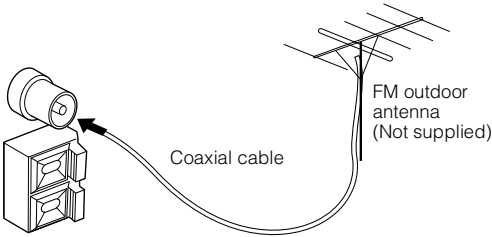

**Using the Coaxial Type Connector (Not Supplied)**

A 75 Ω antenna with coaxial type connector should be connected to the FM 75 Ω COAXIAL terminal.

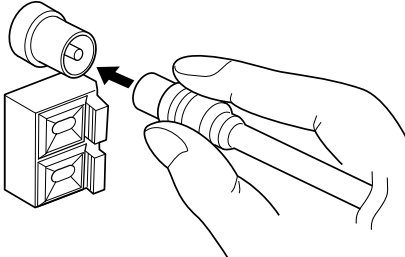

**Note**

- Before attaching a 75 Ω coaxial lead (the kind with a round wire going to an outdoor antenna), disconnect the supplied FM Wire Antenna.

## Connecting the AM Antenna

### Rear Panel of the Center Unit (CA-VSDT2000)

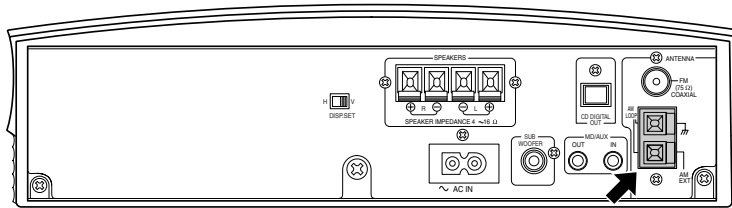

AM loop antenna (Supplied)

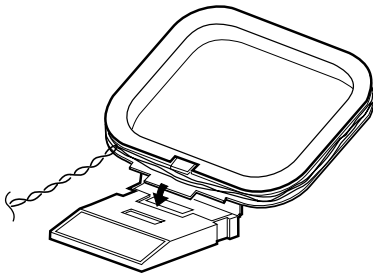

Attach the AM loop to its base by snapping the tabs on the loop into the slot in the base.

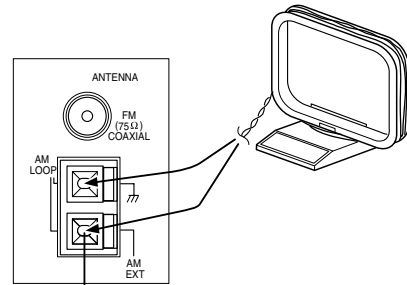

Outdoor single vinyl-covered wire (not supplied)

Turn the loop until you have the best reception.

- The AM loop antenna can be attached to a wall.

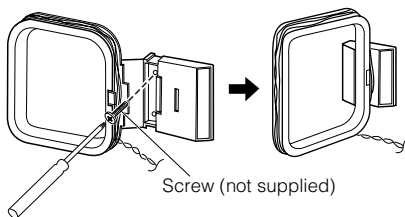

#### Notes

- If the AM loop antenna wire is covered with vinyl, remove the vinyl by twisting it as shown in the diagram.
- Make sure the antenna conductors do not touch any other terminals, connecting cords and power cord. This could cause poor reception.
- If reception is poor, connect an outdoor single vinyl-covered wire to the AM EXT terminal. (Keep the AM loop antenna connected.)





**⚠ CAUTION:**

- Make all connections before plugging the System into an AC power outlet.
- Handling the speakers  
As this is a precision instrument, handle it carefully so as to protect it from shocks.

**Connecting the Speakers (SP-VSDT2000)**

These speakers are exclusively for this system. Using with other devices will damage the speakers.

1. Open each of the terminals to connect the speaker wire leads.
2. Connect the speaker cords to the Speaker terminals of the Unit.  
Connect the cords with a black line to the (-) terminals and cords without a black line to the (+) terminals.
3. Close each of the terminals to securely connect the cords.

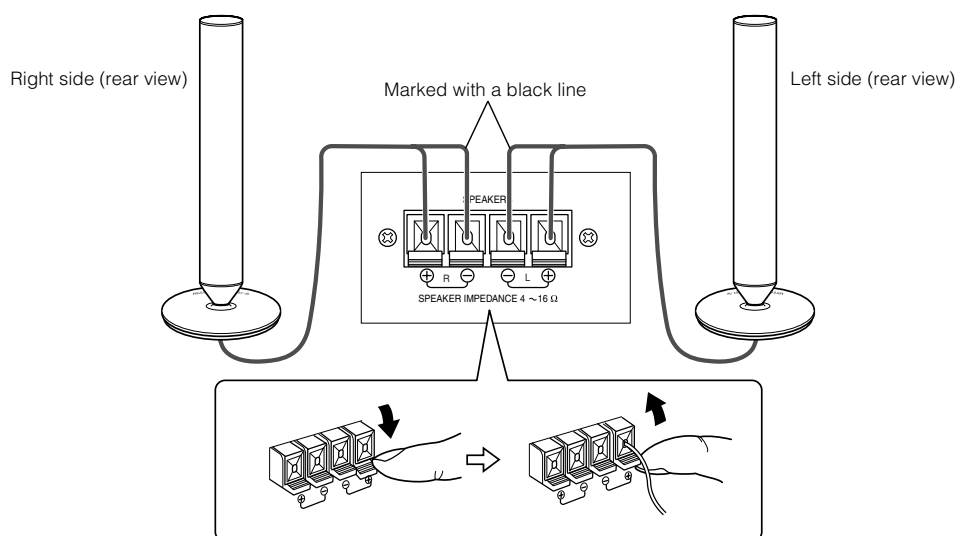
**Notes**

- Since both speakers are the same, you can put either one to the right or left side.
- Do not connect other speakers to the Unit. The difference of the load impedance causes failures.
- Do not use the supplied speakers in parallel with other speakers.

**⚠ CAUTION:**

- A TV may display irregular colors if located near the speakers. If this happens, set the speakers away from the TV.
- Take care not to short-circuit the wire leads for the speakers, as this will damage the center unit (CA-VSDT2000). We recommend that you use the high-quality speaker cord provided. However, if you want to use different cables, please observe the following.
  - 1) Remove the screws on either side and remove the cover.
  - 2) Loosen the terminal screws and remove the speaker cord.

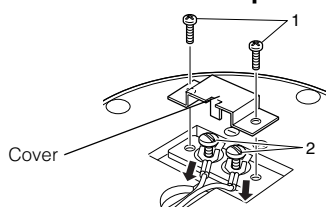
**Warning**

- To prevent short-circuits, always replace the cover.

---

## Attaching the Spacers

---

Attach the supplied spacers to the bottom of the powered subwoofer (SP-PW2000) to protect the cabinet, prevent slipping, and absorb the cabinet vibration. Peel off the backing from a spacer and attach it.

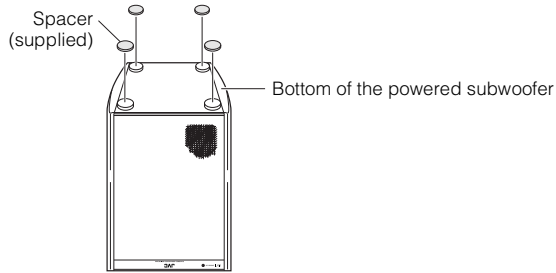

---

## Connecting the Powered Subwoofer (SP-PW2000)

---

Connect a signal cord (supplied) between the System's SUBWOOFER terminal and the LEFT/MONO INPUT terminal of the Powered Subwoofer.

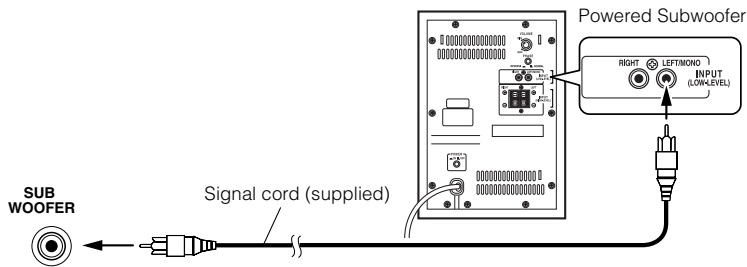

---

## Connecting External Equipment

---

Connect signal cords (not supplied) between the System's MD/AUX-OUT/IN terminals and the output/input terminals of the external MD recorder, tape deck, etc.

You can then listen to the external source through the System or record the System's CD player or tuner to the external unit.

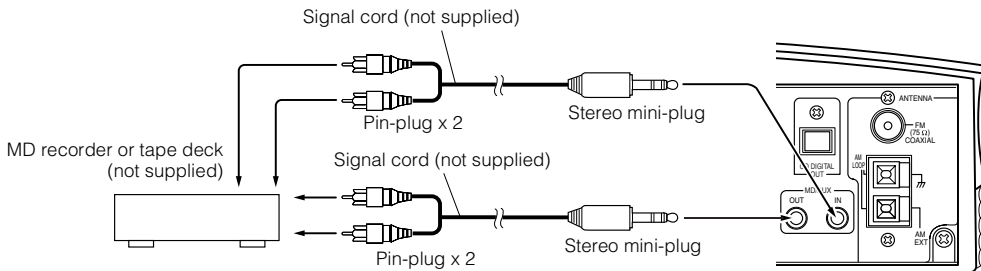

## Connecting an MD Recorder, etc (Digital Output)

Remove the cap and connect an optical digital cord (not supplied) between the System's CD DIGITAL OUT terminal and the input terminal of the MD recorder, etc.

You can record the digital output signal from the System's CD Player to the MD recorder, etc.

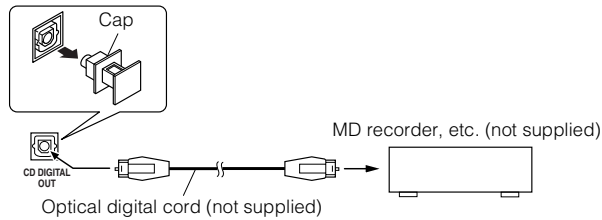

## Connecting the AC Power Cord

Firmly insert the supplied AC power cord into the AC inlet on the back of the Unit. The provided AC power cord for this unit has certain one-way direction connections to prevent electric shock. Refer to the illustration for correct connection.

### ⚠ CAUTIONS:

- ONLY USE THE JVC POWER CORD PROVIDED WITH THIS SYSTEM TO AVOID MALFUNCTION OR DAMAGE TO THE SYSTEM.
- BE SURE TO UNPLUG THE POWER CORD FROM THE OUTLET WHEN GOING OUT OR WHEN THE SYSTEM IS NOT IN USE FOR AN EXTENDED PERIOD OF TIME.

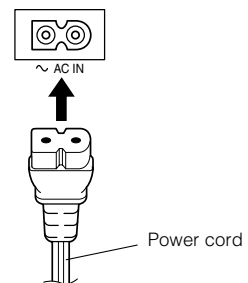

## Installing the Unit on the Stand

You can place the Unit **vertically** by attaching the supplied Stand.

Attach the Stand to the Unit and tighten the screw.

Attach the Legs to the Stand.

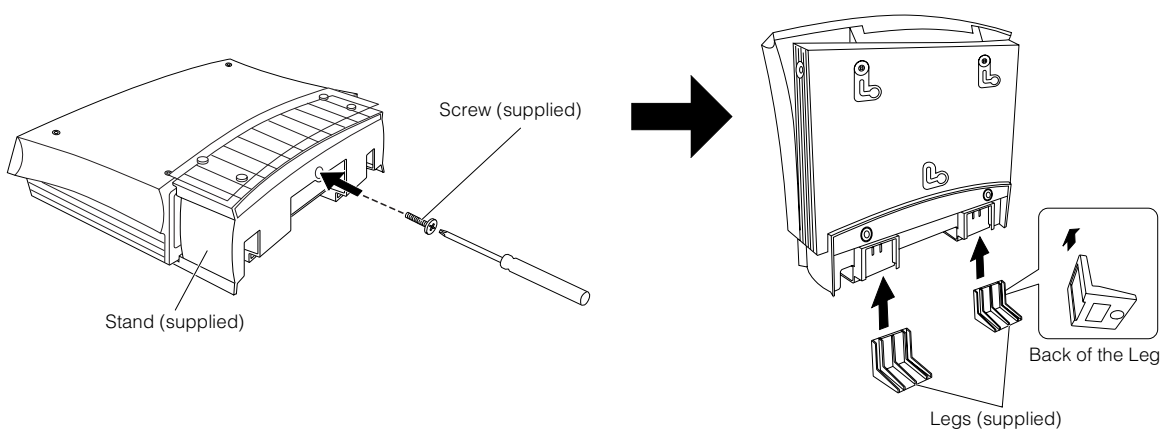

### Note

- Avoid an unstable place when placing the Unit vertically. Select a place on the level surface.

## Installing the Equipment on the Wall

The Center Unit and Speakers can be attached to a wall.

### **CAUTIONS:**

#### Attachment to a wall

- The Center Unit weighs approximately 4.3 kg (9.5 lbs). When its buttons are operated, an additional force will be applied to it in the downward direction. Therefore, sufficient care must be taken when attaching to a wall to prevent any accidents caused by the Center Unit's falling off the wall.
- Before attaching the Center Unit to the wall, check the wall and other related aspects, and verify whether the strength of the wall will be sufficient not only to support the weight of the Center Unit itself but also to withstand the additional downward force which will be applied to it during operation. (Do not attach the Center Unit to a plywood or plasterboard wall. The Center Unit may fall and sustain damage as a result.) If you do not know the strength of the wall and other aspects, consult a qualified service person (such as a qualified constructor).
- The screws needed for attachment are not supplied. Use screws which are compatible with the strength and material of the pillar or wall.
- When attaching the Center Unit to the wall, the screws must be secured tightly in all three locations. Attaching the Center Unit to the wall by making only one or two holes for the screws makes for an unstable attachment and causes a safety hazard as the Center Unit may fall down.

#### Location of attachment to a wall

- Care is required in selecting a location for attaching the Center Unit to the wall. Injury to personnel, or damage to the Center Unit, may result if the Center Unit is attached in a location which interferes with daily activities or a location that the users are liable to knock their bodies or heads against.
- Avoid a location above a bed, sofa, water tank, sink, etc. or in a passage.

### Example of attachment (Center Unit)

The procedure below is intended merely to illustrate how the Center Unit can be attached to a wall and does not make any guarantees for safety while using the Center Unit on a wall. Take into account such factors as the material and strength of the wall, the status of the reinforcing material, and the possible changes that will take place over time.

- The cords must be connected to the Center Unit before attaching to a wall. (See page 4.)

1. Select the place (wooden wall) where the Center Unit is to be attached. Avoid a plywood or plasterboard wall.

2. For reinforcement purposes, prepare the wooden board which will be used to attach the Center Unit to the wall. Before proceeding, check the position of the supports inside the wall. Have ready a sturdy board.

- Thickness: 9 to 15 mm ( $\frac{3}{8}$ " to  $\frac{5}{8}$ " )
- Height: Higher than the unit
- Width: Wider than the distance between the two supports

3. Attach the board to the wall. Anchor the board securely in at least four places to the supports inside the wall. The screws used must have a diameter of at least 4 mm ( $\frac{3}{16}$ " ) and a length equivalent to 3 times the thickness of the board mounted on the wall plus the thickness of the wall itself.

4. Mount three screws (not supplied) onto the board which has now been mounted on the wall. (See the diagram below for the details of the size.)

- The supplied paper pattern will assist in determining the positions of the screws.

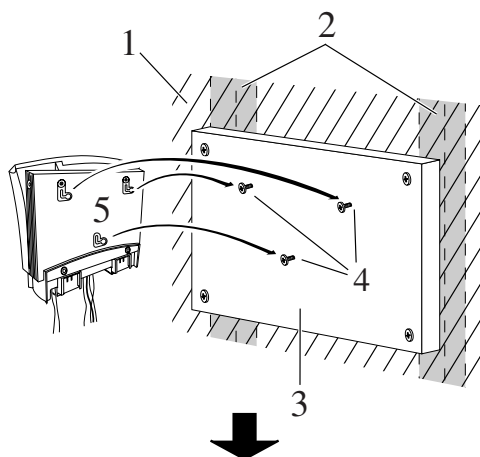
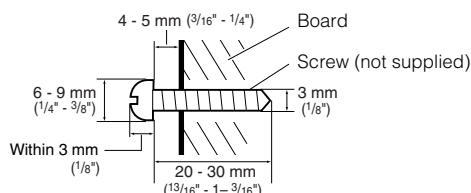

Slide to left, then down.

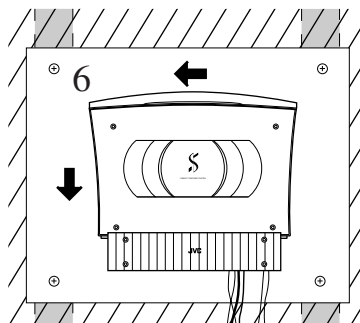

5. Hook the Center Unit onto the attached screws.

6. Slide the Center Unit to the side, and secure it.

- Adjust the screws if the Center Unit is not attached firmly.

## Example of attachment (Speakers)

The speakers can be attached to a wall.  
 Attach the bracket (supplied) to the wall using two screws (not supplied) and place the Speaker onto the bracket.  
 Then, use the wing bolt (supplied) to fix the Speaker firmly to the bracket.

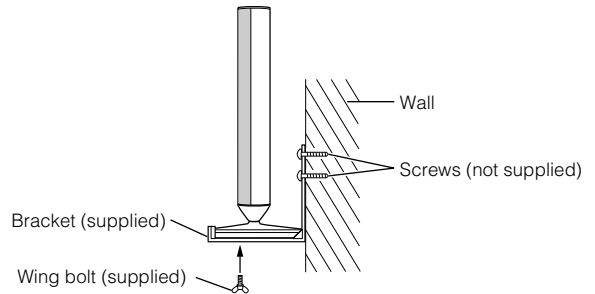

### Notes

- Do not place anything on top of the Center Unit. Doing so may cause the Center Unit to fall, causing malfunctioning and/or injury.
- Do not climb onto the Center Unit or hang from it. Doing so may damage the Center Unit and/or cause injury. Special care must be taken in this respect when there are small children in the home.
- Avoid sandwiching the cords between the Center Unit and wall. This may upset the Center Unit's balance, causing the Center Unit to fall.
- Make sure that the cords will not interfere with daily activities and that the users will not trip over them. Do not pull the connected cords with excessive force.
- Check regularly that none of the screws are loose.
- In the event that the Center Unit has fallen, turn off the power, disconnect its power plug from the power outlet, and contact your dealer for an inspection and repairs. Continued use of the Center Unit may result in a fire or electric shocks.
- Do not place valuables (breakables) underneath the location where the Center Unit is attached. They will be damaged if the Center Unit should fall.
- The manufacturer accepts absolutely no liability for any accidents or damage resulting from inadequate assembly or mounting, insufficient strength of attachment, misuse or abuse, or natural disasters.

**Now you can plug the AC power cord into the wall outlet, and your System is at your command!**

**Before operating, verify that the display shows the clock. If malfunctions may occur, re-connect the power cord.**

## Changing the Display and Control Buttons Settings

You can change the direction of the characters and symbols on the display and the assignment of the functions to each control button on the Unit.  
 Change the settings depending on whether the Unit is placed vertically or horizontally. The factory setting is "V".

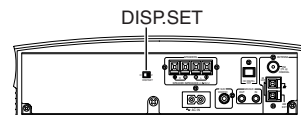

### When the Unit is placed vertically

Set the DISP.SET switch to "V".

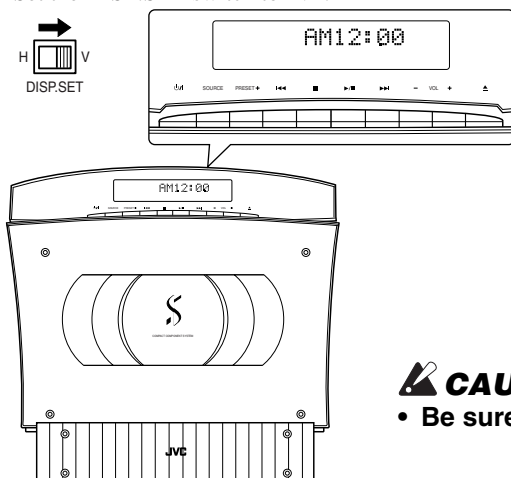

### When the Unit is placed horizontally

Set the DISP.SET switch to "H".

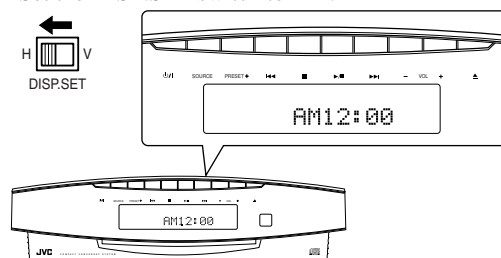

### CAUTION:

- Be sure to turn off the System when changing the settings.

## Getting Started

---

### Using the Remote Control

---

The Remote Control makes it easy to use many of the functions of the System from a distance of up to 7 m (23 feet) away. The remote sensor at which you need to point the Remote Control differs depending on whether the Unit is placed vertically or horizontally.

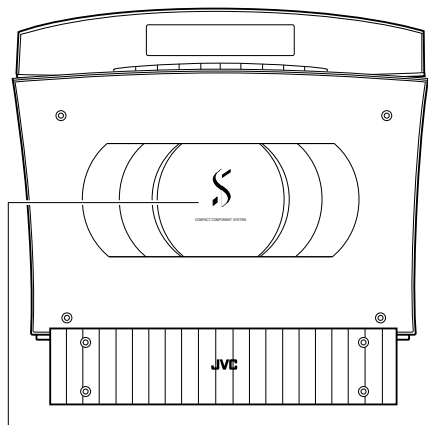

Remote sensor (when the Unit is placed vertically)

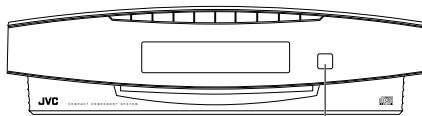

Remote sensor (when the Unit is placed horizontally)

- The maximum operating distance becomes short when the Panel is opened.



#### Note

- Make sure that the "DISP.SET" switch on the rear of the Unit is set correctly.
- 

### COMPU Play

---

JVC's COMPU PLAY feature lets you control the most frequently used System functions with a single touch.

With One Touch Operation you can play a CD, turn on the radio, or listen to an external equipment with a single press of the play button for that function. One Touch Operation turns the power on for you, then starts the function you have specified. If the System is not ready (no CD in place), the System still powers on so you can insert a CD.

How One Touch Operation works in each case is explained in the section dealing with that function.

The COMPU PLAY buttons are:

#### On the Remote Control

- ▶/|| button
- FM/AM button
- MD/AUX button

#### On the Unit

- ▶/|| button
- SOURCE button
- The indicators for the buttons are invisible in Standby mode.  
Check the position of the buttons while the System is turned on.

# Basic Operations

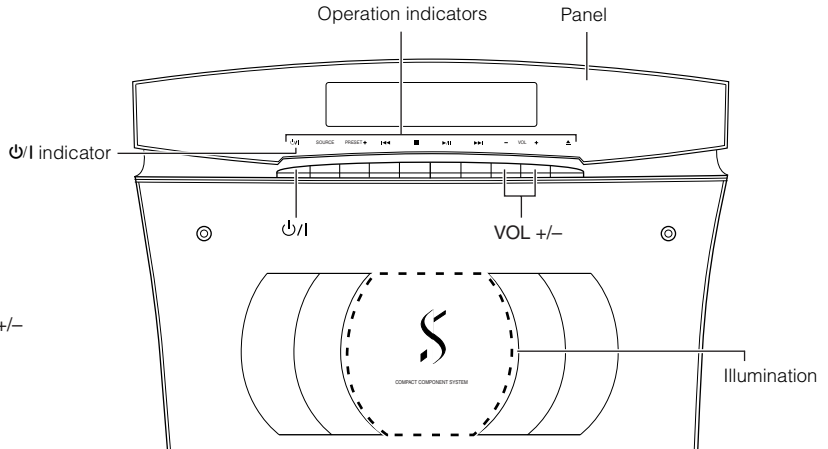
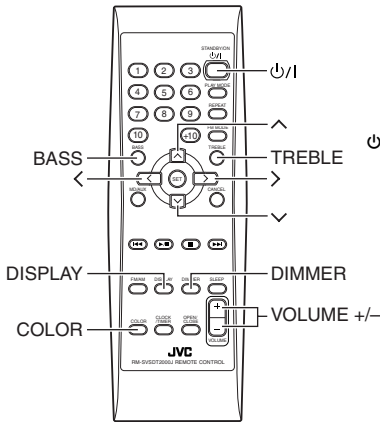

## Turning the Power On and Off

### Turning the System On

Press the  $\mathcal{P}/I$  button.

The display comes on and “HELLO” is displayed once. The operation indicators light on the Panel.

(The Panel opens automatically if the Unit is placed vertically and the DISP.SET switch on the rear of the Unit is set to “V”.)

The System comes on ready to continue in the mode it was in when the power was last turned off.

■ For example, if the last thing you were doing was listening to a CD, you are now ready to listen to a CD again. If you wish, you can change to another source.

■ If you were listening to the Tuner last, the Tuner comes on playing the station it was last set to.

### Turning the System Off

Press the  $\mathcal{P}/I$  button again.

The Panel closes if it has been opened.

“GOOD BYE” is displayed and the display goes out, except for the clock display. The  $\mathcal{P}/I$  indicator (red) remains lit and the rest of the operation indicators go out.

■ Some power is always consumed even though power is turned off (called Standby Mode).

■ To switch off the System completely, unplug the AC power cord from the wall outlet. When you unplug the AC power cord, the clock will be reset to AM 12:00 after about 20 minutes.

#### Power Save Mode

You can reduce the power consumption in standby mode.

Press the DISPLAY button on the Remote Control when the System is turned off.

- The clock display goes out.

### CD-in indicator

While a disc is loaded on the Unit, the CD-in indicator is lit on the display.

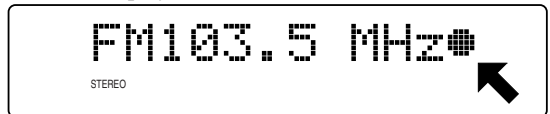

- The CD-in indicator lights while using the Tuner or external equipment and does not light during CD operations.

## Adjusting the Brightness (DIMMER)

### (Using the Remote Control)

You can adjust the brightness of the backlighting for the display and the illumination on the cover.

### When the System is Turned On

Each time you press the DIMMER button on the Remote Control, the brightness of the backlighting and the illumination on the cover change as follows:



Display	Backlighting	Illumination
DIMMER OFF	Bright	Bright
DIMMER 1	Slightly Dark	Slightly Dark
DIMMER 2	Dark	Off



#### Note

- When the System is turned off once, then turned on again, the brightness setting will be restored to the previous one since the setting is stored in memory.

### Changing the Color (COLOR)

#### (Using the Remote Control)

You can change the color of the illumination on the Unit.

- 1 Press the  button to turn on the System.
- 2 Press the COLOR button on the Remote Control.  
"RANDOM COLOR" is displayed.
- 3 Press the  or  button to select the setting of your choice.

The color changes as follows:

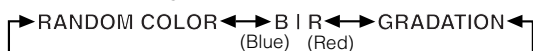

- RANDOM COLOR: The color changes randomly.
- B | R: The color between blue and red is selectable in 16 steps using the > or < button.
- GRADATION: The color changes gradually between blue and red.

### Adjusting the Volume

To increase the volume, press the VOLUME + button on the Remote Control (or VOL + button on the Unit).

To decrease the volume, press the VOLUME - button on the Remote Control (or VOL - button on the Unit).

VOLUME 15

You can adjust the volume level between 0 and 50.

#### CAUTION:

- DO NOT turn off the System with the volume set to an extremely high level; otherwise a sudden blast of sound could damage your hearing, speakers and/or headphones when you turn on the System or start playing any source next time. REMEMBER you cannot adjust the volume level while the System is in standby mode.

#### For private listening

Connect a pair of headphones to the PHONES jack. No sound comes out of the speakers.

Be sure to turn down the volume before connecting or putting on headphones.

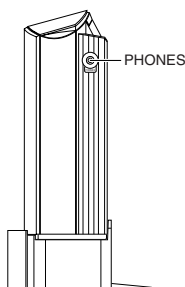



### Tone Control (BASS/TREBLE)

#### (Using the Remote Control)

You can control the tone by changing the bass and treble.

#### BASS Control

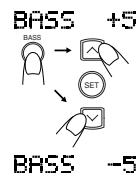

You can adjust the bass level (low frequency range level) between -5 and +5. (0: Flat)

- 1 Press the BASS button on the Remote Control.
- 2 Press the  or  button on the Remote Control to adjust the bass level.





#### TREBLE Control

You can adjust the treble level (high frequency range level) between -5 and +5. (0: Flat)

- 1 Press the TREBLE button on the Remote Control.
- 2 Press the  or  button on the Remote Control to adjust the treble level.

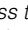

#### Note

- Press the  or  button within 5 seconds to adjust the level after pressing the BASS or TREBLE button.

### Showing the Time (DISPLAY)

#### (Using the Remote Control)

You can show the current time on the display.

To display the clock, press the DISPLAY button on the Remote Control.

To return to the previous mode, press the same button again.

AM 7:00

#### Note

- To let the clock work, you need to set the clock first. (See "Setting the Clock" on page 22.)



# Using the Powered Subwoofer

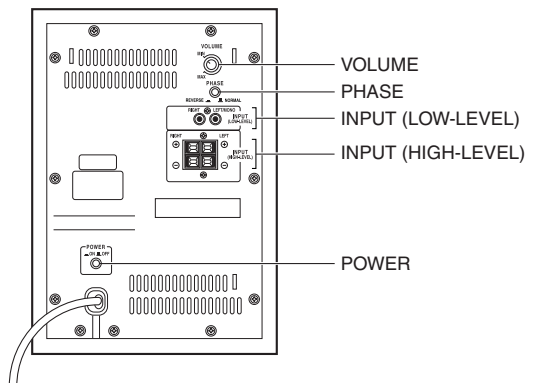
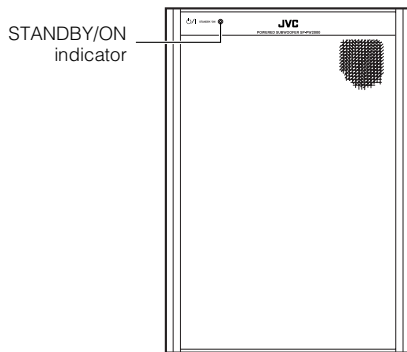

## Operating the Powered Subwoofer

### Presetting the Volume

You need to preset the volume level of this speaker (SP-PW2000) to match those of the main speakers (SP-VSDT2000). Once you preset the volume level, it is stored as your reference level and the volume level of this speaker will be able to automatically change as the volume level of the Center Unit (CA-VSDT2000) changes.

#### 1 Press the **POWER** button of the Subwoofer to turn on the power.

The STANDBY/ON indicator of the Subwoofer will light in **green**.

#### 2 Set the **VOLUME** of the Subwoofer in the "MIN" position.

#### 3 Adjust the volume of the Center Unit to your listening level.

#### 4 Adjust the **VOLUME** of the Subwoofer to balance the volume with the main speakers.

To turn off the Subwoofer, press the POWER button to light off the STANDBY/ON indicator.

### Adding the Richness to the Bass (PHASE)

If you want to add the richness more to the bass, press the PHASE button to set it either in the "REVERSE" position or the "NORMAL" position, whichever can add the richness to the bass.

Normally, the PHASE button should be set in the "NORMAL" position.

### Automatic Operating Status On/Off

To save energy, the Subwoofer enters the Standby mode if no (or very weak) sound signals come into the Subwoofer for about 5 minutes. In Standby mode, the STANDBY/ON indicator of the Subwoofer lights in **red**.

When sound signals come in again, the Subwoofer enters the Operating mode and reproduces the sounds. The STANDBY/ON indicator will light in **green** again.



- The subwoofer may not turn on automatically from the Standby mode in the following cases:
  - when the VOLUME of the Subwoofer is set near "MIN" position.
  - when the volume of the amplifier is set to "0" or the sound signals from the amplifier are extremely weak.

### **CAUTION:**

- Be sure to turn off the **POWER** of the Powered Subwoofer when the Powered Subwoofer is not in use for an extended period of time.

## Using the Powered Subwoofer

### INPUT Terminals

The Subwoofer has the following INPUT terminals.

#### INPUT (LOW-LEVEL):

Usually, the LEFT/MONO terminal is connected to the SUBWOOFER terminal of the Center Unit with the supplied signal cord. (see page 7.)

#### When the Center Unit CA-VSDT2000 is not used (Using other equipment)

If an amplifier etc. to be connected does not have the SUB WOOFER OUT terminals, the RIGHT and LEFT/MONO terminals will be connected to the LINE OUT-RIGHT and LEFT terminals of that unit.

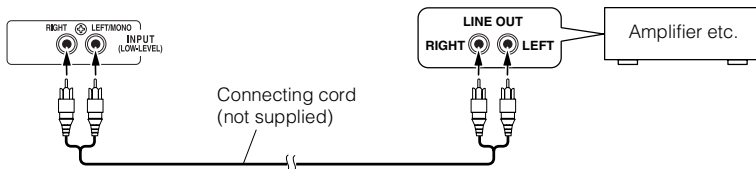

#### INPUT (HIGH-LEVEL):

You can connect the speaker output terminals of other amplifier etc. to these terminals. Connect the speaker cords in parallel to the speaker terminals on the amplifier etc.

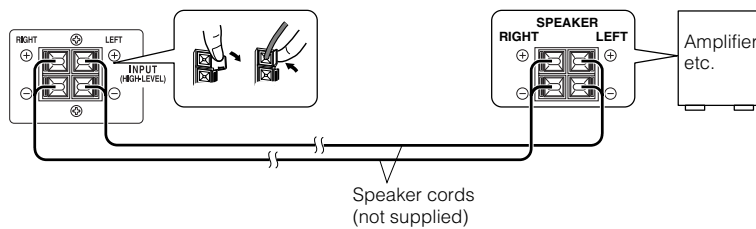

#### Note

- Do not use the INPUT (LOW-LEVEL) terminals and the INPUT (HIGH-LEVEL) terminals at the same time.

# Using the Tuner

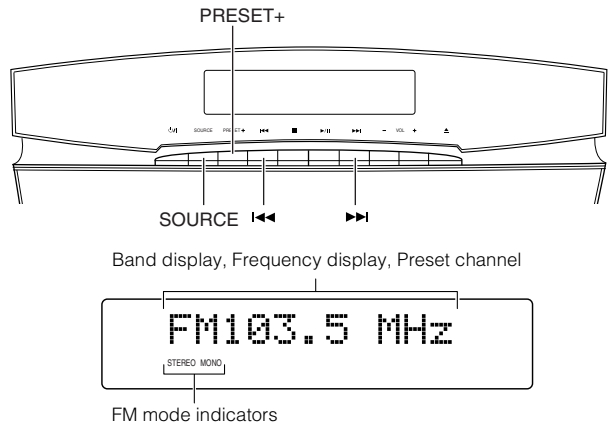
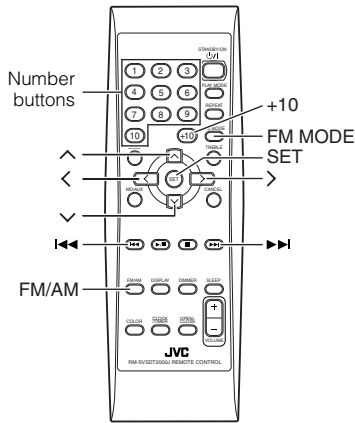

\* When the System is in use, the display shows other items as well.  
For simplicity, we show here only the items described in this section.

You can listen to FM and AM stations. Stations can be tuned in manually, automatically, or from preset memory storage.

- Before listening to the radio:
  - Make sure that both the FM and AM antennas are correctly connected. (See page 4 and 5.)

## One Touch Radio

Just press the FM/AM button on the Remote Control to turn on the System and start playing the station you were last tuned to.

- You can switch from any other sound source to the radio by pressing the FM/AM button on the Remote Control (or the SOURCE button on the Unit).

## Tuning In a Station

### 1 Press the FM/AM button.

The Band and Frequency you were last tuned to appear on the display.  
(If the last station was selected using the preset number, the preset number appears first.)  
Each time you press the button, the band alternates between FM and AM.

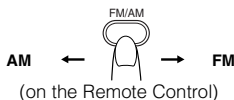

#### ● Using the SOURCE button on the Unit

Each time you press the button, the sound source changes.

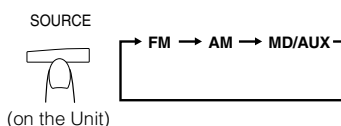

### 2 Select a station using one of the following methods.

#### ● Manual Tuning

Press the ◀◀ or ▶▶ (∧ or ∨) button repeatedly to move from frequency to frequency until you find the station you want.

OR

#### ● Auto Tuning

If you press and hold the ◀◀ or ▶▶ (∧ or ∨) button for one second or more, the frequency changes down, or up, automatically until a station is found.

OR

#### ● Preset Tuning using the Remote Control (Possible only after presetting stations)

Select the desired preset number using the Number buttons on the Remote Control. (For the preset number more than 10, press the +10 button then the Number button.) After 1 second the display will show the preset number's band and frequency.

#### Example:

Press the +10 button then the 2 button continuously.  
The preset number 12 "P12" appears.

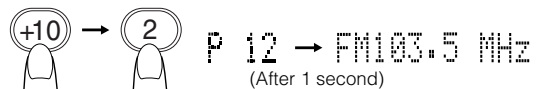

#### ● Preset Tuning using the Unit

Press the PRESET+ button to select the desired preset number.  
Its band and frequency are displayed.

#### Note

- In AM broadcast, reception sensitivity will be changed by turning the AM loop antenna. Turn the AM loop antenna for best reception.

### Presetting Stations

#### (Using the Remote Control)

You can preset up to 30 FM stations and up to 15 AM stations.



- Preset numbers may have been set to factory test frequencies prior to shipment. This is not a malfunction. You can preset the stations you want into memory by following one of the presetting methods below.

#### Manual Presetting

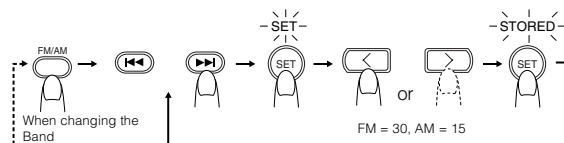

- 1 Select a band by pressing the FM/AM button.**
- 2 Press the  $\ll$  or  $\gg$  ( $\wedge$  or  $\vee$ ) button to tune in a station.**
- 3 Press the SET button.**

“SET” will blink for 5 seconds.  
Within 5 seconds, proceed to the next step.  
When the display returns to the one set in step 2 after 5 seconds, press the SET button again.
- 4 Press the  $>$  or  $<$  button within 5 seconds to select the preset number.**

$>$  or  $<$  button: Increase or decrease the preset number by 1.  
Pressing and holding the button will rapidly increase or decrease the preset number.
- 5 Press the SET button within 5 seconds.**

“STORED” appears and after 2 seconds, the display returns to the broadcast frequency display.
- 6 Repeat above steps 1 to 5 for each station you want to store in memory with a preset number.**

To change the preset stations, repeat the same steps as above.

#### CAUTION:

- Even if the system is unplugged or if the power failure occurs, the preset stations will be stored for about 24 hours. However, in case the preset stations are erased, you will need to preset the stations again.

### To Change the FM Reception Mode

#### (Using the Remote Control)

When you are tuned into an FM stereo broadcast, the “STEREO” indicator lights up and you can hear stereo effects.

If an FM stereo broadcast is hard to receive or noisy, you can select Monaural mode. Reception improves, but you lose stereo effect.

**Press the FM MODE button on the Remote Control so that the “MONO” indicator lights up on the display.**

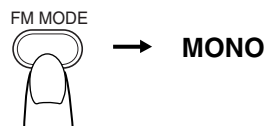

**To restore the stereo effect**, press the FM MODE button on the Remote Control so that the “MONO” indicator goes off.

# Using the CD Player

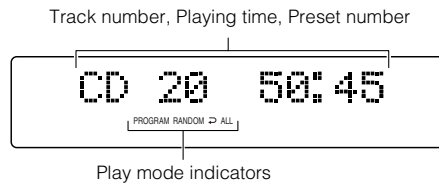
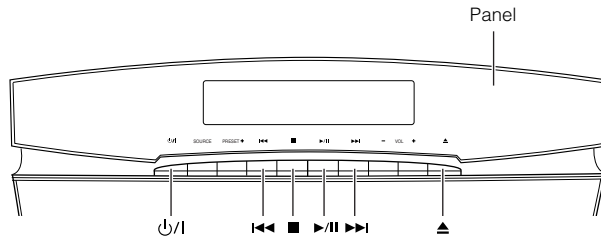
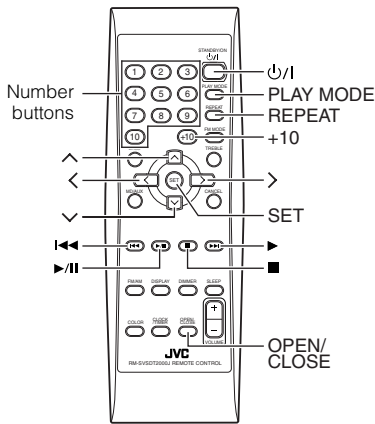

\* When the System is in use, the display shows other items as well.  
For simplicity, we show here only the items described in this section.

You can use Normal, Random, Program or Repeat Play. Repeat Play can repeat all the tracks or just one of the tracks on the CD.

Here are the basic things you need to know to play a CD and locate the different tracks on it.

This unit has been designed to play back the following CDs.

- CD
- CD-R
- CD-RW

### When playing a CD-R or CD-RW

You can play back **finalized CD-R or CD-RW** recorded music CD format.

- You can play back CD-R or CD-RW like CD.
- Some CD-R or CD-RW may not be played back on this unit because of their disc characteristics, damage or stain on them, or if the player lens is dirty.
- The reflection factor of CD-RW is lower than that of other CD, possibly causing CD-RW to take longer to read.

### The Quickest Way To Start a CD Is With the One Touch Operation

- Press the ►/|| button on the Remote Control.
  - The power is automatically turned on. If a CD is already inserted, it will start playing from the first track.
  - If no CD is inserted, "CD NO DISC" appears on the display and the CD Player remains in Stop mode.

## To Insert a CD

### 1 Press the 0/I button.

(When the Unit is placed vertically)

The Panel opens automatically.

(When the Unit is placed horizontally)

To open the Panel, press the ▲ button on the Unit or the OPEN/CLOSE button on the Remote Control.

### 2 Insert a CD into the loading slot, with its label side front or up as shown below.

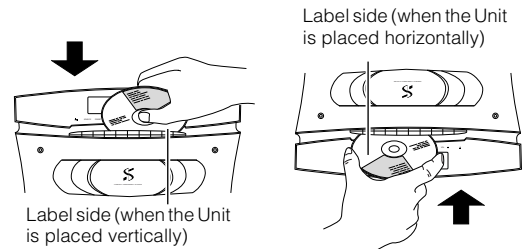

- You can insert an 8 cm (3") CD.
- If the CD cannot be read correctly (because it is scratched or loaded upside down, for example), "CANNOT PLAY" appears on the display.
- You can insert a CD while listening to the other source.

### CAUTIONS:

- DO NOT try to open or close the Panel by hands as it will be damaged. Press the OPEN/CLOSE button on the Remote Control to open or close the Panel.
- DO NOT try to insert another CD when a CD has been already loaded on the Unit. Doing so will damage the CDs and the Unit.

### To Unload a CD

Press the **▲** button on the Unit to eject a CD. The CD is ejected automatically, then take out the CD.

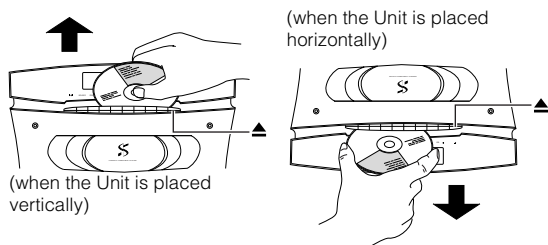

### Basics of Using the CD Player — Normal Play

#### To Play a CD

##### 1 Insert a CD.

##### 2 Press the **▶/||** button.

The first track of the CD begins playing.

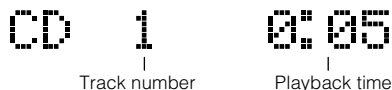

- The CD Player automatically stops when the last track of the CD has finished playing.

To stop playing the CD, press the **■** button. The following information for the CD is displayed.

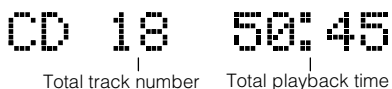

To stop playing and remove the CD, press the **▲** button on the Unit.

To pause, press the **▶/||** button. The playback time blinks on the display.

To cancel pause, press the same button again. Play continues from the point where it was paused.

### To Select a Track or Passage within a Track

In the stop mode or during playback, press the Number button on the Remote Control to select the track you want.

- The selected track starts playing.
- For the track number more than 10, press the +10 button then the Number button.

OR

During playback, press the **◀◀** or **▶▶** button to select the track you want.

- The selected track starts playing.
- Press the **▶▶** button once to skip to the beginning of the next track.
- Press the **◀◀** button to skip to the beginning of the track being played. Press twice quickly to skip to the beginning of the previous track.

### Search Play

Holding down the **◀◀** or **▶▶** button, during playback, will fast forward/backwards the CD so you can quickly find a particular passage in the track you are listening to.



- The < or > and ^ or v buttons on the Remote Control operate same as the **◀◀** or **▶▶** button does.

### Programming the Playing Order of the Tracks

#### (Using the Remote Control)

You can program the playing order of the tracks.

- You can program up to 32 tracks in any desired order including the same tracks.
- You can only make a program when the CD Player is stopped.

##### 1 Insert a CD.

##### 2 Press the **▶/||** button.

##### 3 Press the **■** button to stop the CD.

##### 4 Press the **PLAY MODE** button on the Remote Control until the “PROGRAM” indicator lights up.



(To be continued on the next page)

## 5 Press the Number button to select the track to program.

Each time you press the Number button, the selected track is added to the program.

- For the track number more than 10, press the +10 button then the Number button.

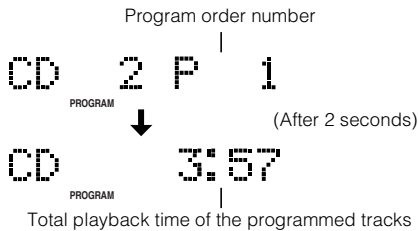

## 6 Repeat step 5 to select the other tracks for the program.

You can see the total playback time of programmed tracks on the display.

## 7 Press the ►/|| button.

The System plays the tracks in the order you have programmed them.

- You can skip to a particular program track by pressing the ◀◀ or ▶▶ button during Program Play.
- To stop playing, press the ■ button once.

**To confirm the programmed tracks while the CD player is stopped,** each time press the ◀◀ or ▶▶ button; the tracks making up the program will successively be displayed in the programmed order.

**To exit the program mode once,** while the CD Player is stopped, press the PLAY MODE button to light off the “PROGRAM” indicator.



- If the total playback time of the programmed tracks exceeds 99 minutes 59 seconds, “-- : --” will appear on the display.

## To Modify the Program

Modify the contents of the program while the CD Player is stopped.

Each time you press the CANCEL button, the last track in the program is deleted. To add new tracks to the end of the program, repeat above step 5.

- To delete the all tracks in the program, press the CANCEL button for over 2 seconds.

## Random Play

### (Using the Remote Control)

The tracks will play in no special order when you use this mode.

- To enter Random Play mode, stop playback first.

### 1 Press the PLAY MODE button on the Remote Control until the “RANDOM” indicator lights.

### 2 Press the ►/|| button.

The tracks are played in random order.

**To skip a track during playback,** press the ▶▶ button to jump to the next track in the random sequence. Press the ◀◀ button to jump back to the start of a track being played.

**To exit Random Play mode,** while the CD Player is stopped, press the PLAY MODE button to light off the “RANDOM” indicator and carry out Normal Play.

## Repeating Tracks

### (Using the Remote Control)

You can repeat all tracks or individual track, as many times as you like.

### Press the REPEAT button on the Remote Control.

The Repeat indicator changes with each press of the button, as shown below.

☞ → ☞ ALL → blank display → (back to the beginning)

☞ : Repeats one track.

☞ ALL: In Normal Play mode, repeats all the tracks. In Program Play mode, repeats all the tracks in the program.

In Random Play mode, repeats all the tracks in random order.

**To exit Repeat mode,** press the REPEAT button until the Repeat indicator on the display goes out.

- Repeat mode remains in effect even when you change the play mode.

## Child Lock

You can prevent the unwanted CD ejection by locking.

- Before proceeding, check the position of the ▶▶ button on the Unit, then **turn off the System.**

### To Lock the CD Ejection

Hold down the ▶▶ button and press the ☞/| button on the Unit.

“LOCKED” appears on the display.

### To Release the Lock

Perform the same procedure when you locked.

“UNLOCKED” appears on the display.

# Using External Equipment

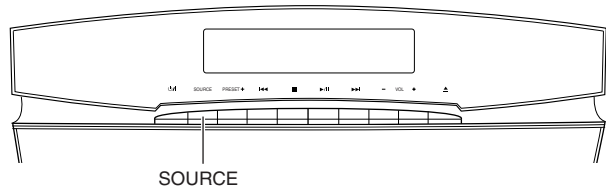
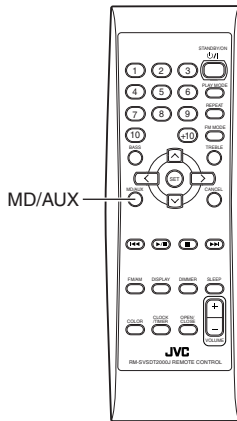

## Listening to External Equipment

You can listen to external equipment such as MD recorder, cassette deck or other auxiliary.

- First make sure that the external equipment is properly connected to the System. (See page 7.)

### 1 Press the MD/AUX button.

“MD/AUX” appears on the display.

MD/AUX

- On the Unit, press the SOURCE button until “MD/AUX” appears on the display.

### 2 Start playing the external equipment.



- For operation of the external equipment, refer to its Instructions.

## Recording the System's Source to External Equipment

You can record the System's source to external equipment which is connected to the MD/AUX-IN/OUT or CD DIGITAL OUT terminals of the System, such as cassette deck or MD recorder, etc.

- First make sure that the external equipment is properly connected to the System. (See page 7.)

### 1 Play the System's CD Player or tune in to a station.

- The recording level is not affected by the VOLUME level set by the System. Also it is not affected by the sound effects.



- For operation of the external equipment, refer to its Instructions.
- While using the tuner, no signals come out from the CD DIGITAL OUT terminal.



# Using the Timers

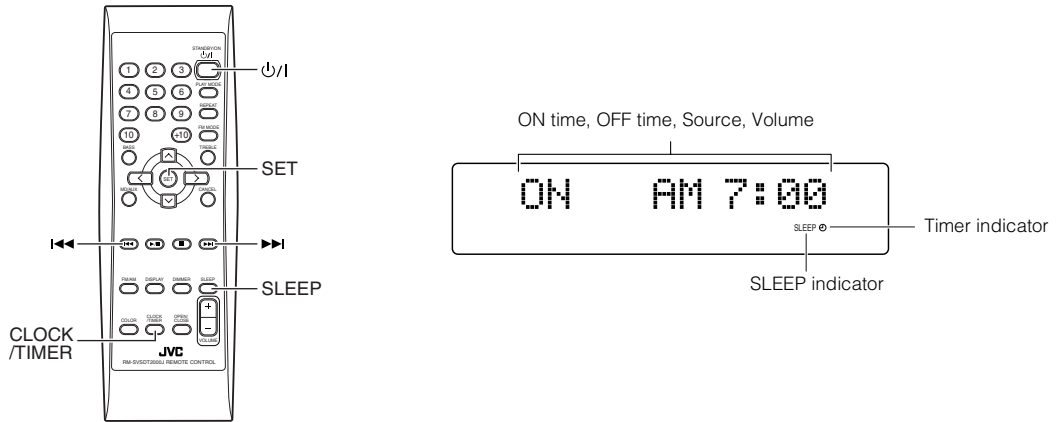

\* When the System is in use, the display shows other items as well.  
For simplicity, we show here only the items described in this section.

The timers let you control listening functions automatically.

## Setting the Clock

### (Using the Remote Control)

- When you plug the AC power cord into the wall outlet, the time indication “AM 12:00” blinks on the display.



- The clock must be correctly set for the timers to work.

### 1 Press the **ON/OFF** button.

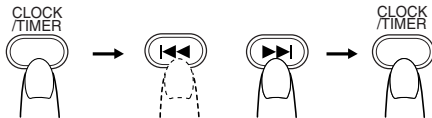

### 2 Press the **CLOCK/TIMER** button on the Remote Control.

The hour digit of the time indication rapidly blinks on the display.

### 3 Press the **▶▶** or **◀◀** button on the Remote Control to set the hour.

Pressing the **▶▶** button moves the time forwards and pressing the **◀◀** button moves it backwards. Hold down the button to move the time rapidly.

### 4 Press the **SET** button.

The minute digits of the time indication rapidly blink on the display.

### 5 Press the **▶▶** or **◀◀** button to set the minute.

### 6 Press the **SET** button.

The selected time is set and the seconds start counting from 0.

### **CAUTION:**

- If there is a power failure, the clock loses its setting after about 20 minutes. “AM 12:00” blinks on the display and the clock must be reset.

### **Notes**

- The clock may gain or lose one to two minutes per month.
- The **^** or **∨** button operates same as the **▶▶** or **◀◀** button does.

## Setting the Daily Timer

### (Using the Remote Control)

Once you have set the Daily Timer, the timer will be activated at the same time every day.

The Timer indicator (☉) on the display shows that the Daily Timer you have set is in effect.

- When the Timer Indicator (☉) is displayed, the timer is activated.
- When the Timer Indicator (☉) is not displayed, the timer is deactivated.

### 1 Setting the ON time (Example: AM 10:15).

1. Press the CLOCK/TIMER button on the Remote Control.  
"TIMER" appears on the display.

TIMER

- When the clock is not set, "AM 12:00" appears on the display. Set the clock first.
2. Press the CLOCK/TIMER button again. The hour digit of the "ON" time blinks on the display.

ON AM 10:00

Press the ►► or ◄◄ button on the Remote Control to set the hour you want the Unit to come on. Pressing the ►► button moves the time forwards and pressing the ◄◄ button moves it backwards. Hold down the button to move the time rapidly.

ON AM 10:00

3. Press the SET button.  
The minute digits of the ON time blink on the display.

ON AM 10:00

Set the minute you want the Unit to come on, using the ►► or ◄◄ button.

ON AM 10:15

### 2 Setting the OFF time (Example: PM 1:30).

1. Press the SET button.  
The hour digit of the OFF time blinks on the display. (The same time as the ON time will be automatically set.)

OFF AM 1:00

Set the hour you want the Unit to be turned off, using the ►► or ◄◄ button.

OFF PM 1:00

2. Press the SET button.  
The minute digits of the OFF time blink on the display.

OFF PM 1:00

Set the minute you want the Unit to be turned off, using the ►► and ◄◄ buttons.

OFF PM 1:30

### 3 Selecting the music source.

1. Press the SET button.  
The "TUNER" or "CD" blinks on the display.
2. Press the ►► or ◄◄ button to select the music source you want to listen to.  
The display changes as shown below.  
TUNER◄CD►(back to the beginning)

### 4 Setting the volume level.

1. Press the SET button.  
The current volume setting blinks on the display.
2. Press the ►► or ◄◄ button to select the volume level.  
-- :The current volume level will be used.  
0 to 50 :When the timer is turned on, the Volume will be automatically set to the selected level.

VOLUME 15

### 5 Press the SET button.

The timer setting is completed and the Timer indicator (☉) appears on the display. The display shows the each setting of the Timer and returns to the display before you set the Timer.

(To be continued on the next page)

## 6 Before turning off the System, prepare the music source selected in step 3.

TUNER: Tune in to the desired station.

CD: Insert a CD. (Playback will start from the first track at Timer on.)

## 7 Press the button to turn off the System.

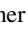
In standby mode, you can see the Timer indicator (  ) on the display.

- When the timer turns on, the Timer indicator starts blinking and the prepared source in step 6 will be played.

### To confirm the timer setting

Press the CLOCK/TIMER button, then press the SET button. Each setting appears on the display.

### To cancel the timer

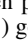
Press the CLOCK/TIMER button, then press the CANCEL button. The Timer indicator (  ) goes out.

### To re-activate the cancelled timer

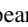
Press the CLOCK/TIMER button, then press the SET button. The Timer indicator (  ) appears.

### To change the timer setting

Repeat the setting procedure from the beginning.

## CAUTION:

- If the System is unplugged, or a power failure occurs, the timer setting will be lost. You will need to reset the clock first, then the timer.

## Setting the SLEEP Timer

### (Using the Remote Control)

Use the Sleep Timer to turn the System off after a certain number of minutes when it is playing. By setting the Sleep Timer, you can fall asleep to music and know that your System will turn off by itself rather than play all night.

- You can only set the Sleep Timer when the System is on and a source is playing.

### 1 Play a CD or tune in to the desired station.

### 2 Press the SLEEP button on the Remote Control.

The “SLEEP” indicator lights up.

- When the clock is not set, “AM 12:00” appears on the display. Set the clock at first.

### 3 Set the length of time you want the source to play before shutting off.

- Each time you press the SLEEP button, it changes the number of minutes shown on the display in this sequence:

**10 → 20 → 30 → 60 → 90 → 120 → Cancelled → (back to the beginning)**

The selected number of minutes for the Sleep Timer will disappear five seconds later and the display returns to the original one before setting the Sleep Timer. (The display is dimmed.)

The System is now set to turn off after the number of minutes you set.

### To Confirm the Sleep Time:

When the SLEEP button is pressed, the remaining sleep time is displayed. Wait until the display returns to the original display.

### To Cancel the SLEEP Timer Setting:

Press the SLEEP button until the “SLEEP” indicator goes out on the display.

Turning off the System also cancels the SLEEP Timer.

- If you are setting the Daily Timer, the System will be turned on at the set time to wake you up.

# Care And Maintenance

Handle your CDs carefully, and they will last a long time.

## Compact Discs

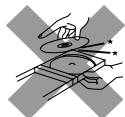
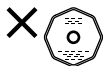

- Only CDs bearing this mark can be used with this System. However, continued use of irregular shape CDs (heart-shape, octagonal, etc.) can damage the System.

- Remove the CD from its case by holding it at the edges while pressing the case's center hole lightly.
- Do not touch the shiny surface of the CD, or bend the CD.

- Put the CD back in its case after use to prevent warping.
- Be careful not to scratch the surface of the CD when placing it back in the case.
- Avoid exposure to direct sunlight, temperature extremes, and moisture.

- A dirty CD may not play correctly. If a CD does become dirty, wipe it with a soft cloth in a straight line from center to edge.

## CAUTION:

- Do not use any solvent (for example, conventional record cleaner, spray thinner, benzene, etc.) to clean a CD.

## General Notes

In general, you will have the best performance by keeping your CDs and the mechanism clean.

- Store CDs in their cases, and keep them in cabinets or on shelves.
- Keep the System's Panel closed when not in use.

## Cleaning the unit

- Stains on the unit  
Should be wiped off with a soft cloth. If the unit is heavily stained, wipe it with a cloth soaked in water-diluted neutral detergent and wrung well, then wipe clean with a dry cloth.
- Since the unit may deteriorate in quality, become damaged or get its paint peeled off, be careful about the followings.
  - DO NOT wipe it with a hard cloth.
  - DO NOT wipe it strong.
  - DO NOT wipe it with thinner or benzene.
  - DO NOT apply any volatile substance such as insecticides to it.
  - DO NOT allow any rubber or plastic to remain in contact with it for a long time.

## Moisture Condensation



Moisture may condense on the lens inside the System in the following cases:

- After turning on heating in the room.
  - In a damp room.
  - If the System is brought directly from a cold to a warm place.
- Should this occur, the System may malfunction. In this case, leave the System turned on for a few hours until the moisture evaporates, unplug the AC power cord, and then plug it in again.

# Troubleshooting

- If you are having a problem with your System, check this list for a possible solution before calling for service.
- If you cannot solve the problem from the hints given here, or the System has been physically damaged, call a qualified person, such as your dealer, for service.

Symptom	Possible Cause	Action
No sound is heard.	<ul style="list-style-type: none"> <li>• Connections are incorrect, or loose.</li> <li>• Headphones are connected.</li> </ul>	<ul style="list-style-type: none"> <li>• Check all connections and make corrections. (See pages 4 to 8.)</li> <li>• Disconnect the headphones.</li> </ul>
Poor radio reception	<ul style="list-style-type: none"> <li>• The antenna is disconnected.</li> <li>• The AM Loop Antenna is too close to the System.</li> <li>• The FM Wire Antenna is not properly extended and positioned.</li> </ul>	<ul style="list-style-type: none"> <li>• Reconnect the antenna securely.</li> <li>• Change the position and direction of the AM Loop Antenna.</li> <li>• Extend FM Wire Antenna to the best reception position.</li> </ul>
The CD skips.	The CD is dirty or scratched.	Clean or replace the CD.
The CD does not play.	The CD is upside down.	Put the CD in with the label side up.
Unable to operate the Remote Control.	<ul style="list-style-type: none"> <li>• The path between the Remote Control and the sensor on the Unit is blocked.</li> <li>• The batteries have lost their charge.</li> </ul>	<ul style="list-style-type: none"> <li>• Remove the obstruction.</li> <li>• Replace the batteries.</li> </ul>
Operations are disabled.	The built-in microprocessor has malfunctioned due to external electrical interference.	Unplug the System then plug it back in.
"CD NO DISC" appears.	There is no disc loaded.	Insert a disc.
"CANNOT PLAY" or "UNFINALIZ" appears.	<ul style="list-style-type: none"> <li>• The CD-R or CD-RW that hasn't yet been finalized (including blank discs) has been inserted.</li> <li>• The disc has been inserted with its label side down.</li> </ul>	<ul style="list-style-type: none"> <li>• Insert a CD-R or CD-RW that has been finalized.</li> <li>• Remove the disc and insert it with the label side front or up. (See page 18.)</li> </ul>
The characters and symbols on the display appear upside down.	The DISP.SET switch on the rear panel of the Center Unit has not been set correctly.	Set the DISP.SET switch correctly. (See page 10.)
Subwoofer automatically turns on, but no sound is output.	The volume knob of the Subwoofer is set to MIN position.	Adjust the volume knob.
Subwoofer does not automatically turn on.	The volume knob of the Subwoofer is set to MIN position. Also, the volume level of the Center Unit is low.	Adjust both volume levels.



# LIMITED WARRANTY

AUDIO-1

JVC COMPANY OF AMERICA warrants this product and all parts thereof, except as set forth below ONLY TO THE ORIGINAL PURCHASER AT RETAIL to be FREE FROM DEFECTIVE MATERIALS AND WORKMANSHIP from the date of original retail purchase for the period as shown below. ("The Warranty Period")

PARTS	<b>1 YR</b>	LABOR	<b>1 YR</b>
-------	-------------	-------	-------------

THIS LIMITED WARRANTY IS VALID ONLY IN THE FIFTY (50) UNITED STATES, THE DISTRICT OF COLUMBIA AND IN COMMONWEALTH OF PUERTO RICO.

**WHAT WE WILL DO:**

If this product is found to be defective, JVC will repair or replace defective parts at no charge to the original owner. Such repair and replacement services shall be rendered by JVC during normal business hours at JVC authorized service centers. Parts used for replacement are warranted only for the remainder of the Warranty Period. All products and parts thereof may be brought to a JVC authorized service center on a carry-in basis except for Television sets having a screen size 25 inches and above which are covered on an in-home basis.

**WHAT YOU MUST DO FOR WARRANTY SERVICE:**

Return your product to a JVC authorized service center with a copy of your bill of sale. For your nearest JVC authorized service center, please call toll free: (800) 537-5722.

If service is not available locally, box the product carefully, preferably in the original carton, and ship, insured, with a copy of your bill of sale plus a letter of explanation of the problem to the nearest JVC Factory Service Center, the name and location of which will be given to you by the toll-free number.

If you have any questions concerning your JVC Product, please contact our Customer Relations Department.

**WHAT IS NOT COVERED:**

This limited warranty provided by JVC does not cover:

1. Products which have been subject to abuse, accident, alteration, modification, tampering, negligence, misuse, faulty installation, lack of reasonable care, or if repaired or serviced by anyone other than a service facility authorized by JVC to render such service, or if affixed to any attachment not provided with the products, or if the model number or serial number has been altered, tampered with, defaced or removed;
2. Initial installation and installation and removal for repair;
3. Operational adjustments covered in the Owner's Manual, normal maintenance, video and audio head cleaning;
4. Damage that occurs in shipment, due to act of God, and cosmetic damage;
5. Signal reception problems and failures due to line power surge;
6. Video Pick-up Tubes/CCD Image Sensor, Cartridge, Stylus (Needle) are covered for 90 days from the date of purchase;
7. Accessories
8. Batteries (except that Rechargeable Batteries are covered for 90 days from the date of purchase);

There are no express warranties except as listed above.

THE DURATION OF ANY IMPLIED WARRANTIES, INCLUDING THE IMPLIED WARRANTY OF MERCHANTABILITY, IS LIMITED TO THE DURATION OF THE EXPRESS WARRANTY HEREIN.

JVC SHALL NOT BE LIABLE FOR THE LOSS OF USE OF THE PRODUCT, INCONVENIENCE, LOSS OR ANY OTHER DAMAGES, WHETHER DIRECT, INCIDENTAL OR CONSEQUENTIAL (INCLUDING, WITHOUT LIMITATION, DAMAGE TO TAPES, RECORDS OR DISCS) RESULTING FROM THE USE OF THIS PRODUCT, OR ARISING OUT OF ANY BREACH OF THIS WARRANTY. ALL EXPRESS AND IMPLIED WARRANTIES, INCLUDING THE WARRANTIES OF MERCHANTABILITY AND FITNESS FOR PARTICULAR PURPOSE, ARE LIMITED TO THE WARRANTY PERIOD SET FORTH ABOVE.

Some states do not allow the exclusion of incidental or consequential damages or limitations on how long an implied warranty lasts, so these limitations or exclusions may not apply to you. This warranty gives you specific legal rights and you may also have other rights which vary from state to state.

**JVC COMPANY OF AMERICA**                      1700 Valley Road  
 DIVISION OF JVC AMERICAS CORP.            Wayne, NJ 07470

REFURBISHED PRODUCTS CARRY A SEPARATE WARRANTY, THIS WARRANTY DOES NOT APPLY. FOR DETAILS OF REFURBISHED PRODUCT WARRANTY, PLEASE REFER TO THE REFURBISHED PRODUCT WARRANTY INFORMATION PACKAGED WITH EACH REFURBISHED PRODUCT.

**For customer use:**

Enter below the Model No. which is located either on the rear, bottom or side of the cabinet. Retain this information for future reference.

Model No. : \_\_\_\_\_ Serial No. : \_\_\_\_\_

Purchase data : \_\_\_\_\_ Name of dealer : \_\_\_\_\_

# Authorized Service Centers

---

QUALITY **JVC**<sup>®</sup> SERVICE

*HOW TO LOCATE YOUR JVC SERVICE CENTER*

**TOLL FREE: 1 (800) 537-5722**

**<http://www.jvc.com>**

Dear Customer,

In order to receive the most satisfaction from your purchase, please read the instruction booklet before operating the unit. In the event that repairs are necessary, please call 1 (800)537-5722 for your nearest authorized servicer or visit our website at **[www.JVC.com](http://www.JVC.com)**

Remember to retain your Bill of Sale for Warranty Service.

---

**Do not service the television yourself**

---

## **Caution**

To prevent electrical shock, do not open the cabinet. There are no user serviceable parts inside.

Please refer to qualified service personnel for repairs.

## **Accessories**

To purchase accessories for your JVC product, please call toll free:1 (800)882-2345 or on the web at **[www.JVC.com](http://www.JVC.com)**

---

# Specifications

## CA-VSDT2000

### Amplifier

Output Power	19 W per channel, min. RMS, at 4 Ω from 180 Hz to 20 kHz, with no more than 10% total harmonic distortion
Input Sensitivity/Impedance (1 kHz)	
MD/AUX IN	500 mV/47 kΩ
Output Sensitivity/Impedance (1 kHz)	
MD/AUX OUT	500 mV/5 kΩ
CD DIGITAL OUT (Optical out)	-21 dBm - -15 dBm
Speaker terminals	4 Ω - 16 Ω
Subwoofer out	440 mV/6 kΩ
Phones	16 Ω - 1 kΩ
	0 - 15 mW/ch output into 32 Ω

### CD Player

Signal-To-Noise Ratio	100 dB
Wow And Flutter	Unmeasurable

### Tuner

FM Tuner	
Tuning Range	87.5 MHz - 108.0 MHz
AM Tuner	
Tuning Range	530 kHz - 1 710 kHz

### Power Specifications

Power Requirements	AC 120 V ~, 60 Hz
Power Consumption	36 W (power on mode) 2.5 W (power save mode)

### Center Unit

Dimensions*	325 mm × 86 mm × 237 mm (W/H/D) (12 - <sup>13</sup> / <sub>16</sub> " × 3 - <sup>7</sup> / <sub>16</sub> " × 9 - <sup>3</sup> / <sub>8</sub> ")
Mass*	Approx. 4.0 kg (8.9 lbs)

\* without Stand and Legs

## Speaker Specifications (each unit)

### SP-VSDT2000

Speakers	9.5 cm × 1 cm (3 - <sup>3</sup> / <sub>4</sub> " × <sup>7</sup> / <sub>16</sub> ") track-type dome
Impedance	4 Ω
Dimensions	125 mm × 317 mm × 125 mm (W/H/D) (4 - <sup>15</sup> / <sub>16</sub> " × 2 - <sup>1</sup> / <sub>2</sub> " × 4 - <sup>15</sup> / <sub>16</sub> ")
Mass	560 g (1.3 lbs)

### Powered Subwoofer (SP-PW2000)

Speaker	Woofer 16 cm (6 - <sup>5</sup> / <sub>16</sub> ") (4 Ω) × 1
Rated Impedance	4 Ω
Frequency Response	30 Hz- 280 Hz
Input sensitivity/Impedance	
LOW LEVEL	500 mV/50 kΩ
HIGH LEVEL	2.1 V/1 kΩ
Output Power	60 W, min. RMS, at 4 Ω from 40 Hz to 280 Hz, with no more than 10% total harmonic distortion
Power requirements	AC 120 V ~, 60 Hz
Power consumptions	31 W
Dimensions	226 mm × 295 mm × 315 mm (W/H/D) (8 - <sup>15</sup> / <sub>16</sub> " × 11 - <sup>5</sup> / <sub>8</sub> " × 12 - <sup>7</sup> / <sub>16</sub> ")
Mass	7.7 kg (17.0 lbs)

### Accessories

- Power Cord (1)
- AM Loop Antenna (1)
- Remote Control (1)
- Batteries R6P (SUM-3)/AA (15F) (2)
- FM Wire Antenna (1)
- Signal Cord (1)
- Spacers (4) (for SP-PW2000)
- Stand (1) (for Center Unit)
- Legs (2) (for Stand)
- Screw (1) (for Stand)
- Brackets (2) (for SP-VSDT2000)
- Wing Bolts (2) (for SP-VSDT2000)
- Paper Pattern (1)

## Dimensions for Installation (CA-VSDT2000)

### Vertical Position

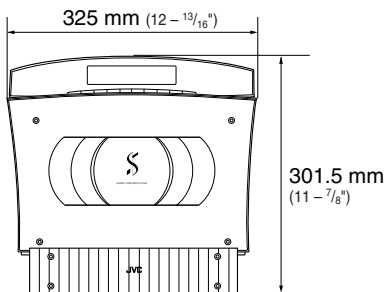

### (On the wall)

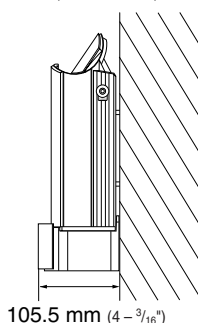

### (With Legs)

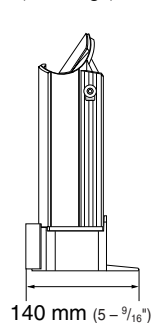

### Horizontal Position

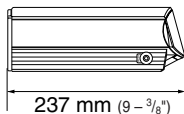
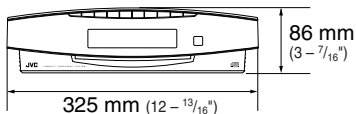

Design and specifications are subject to change without notice.

# JVC

VICTOR COMPANY OF JAPAN, LIMITED